

## 1 | Overview

This keypad is a SDI2 bus compatible device.

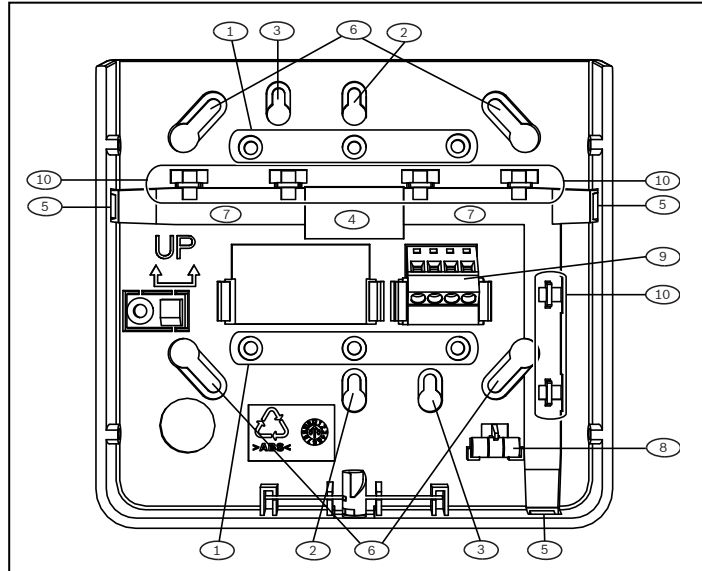

### Callout – Description

1 – Wall mount holes
2 – Single gang box holes
3 – Double gang box holes
4 – Wire opening
5 – Surface mount wire openings
6 – Gang box holes (3-4 in)
7 – Surface mount wire channel
8 – Bubble level
9 – SDI2 wiring terminal block
10 – Wire tie posts

## 2 | SDI2 address switches

Two switches set the address for the keypad. The control panel uses the address for communication.

## 2.1 | Access the address switches

1. Use a slotted screwdriver. Turn the lock counter-clockwise.
2. Push down on the keypad to remove it from the base.
3. Find the switches on the back of the keypad. Refer to the following illustrations.

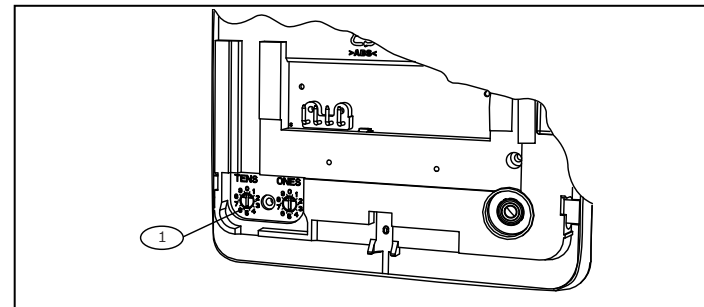
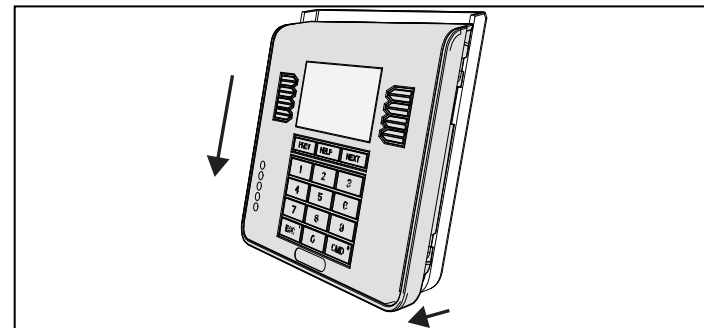
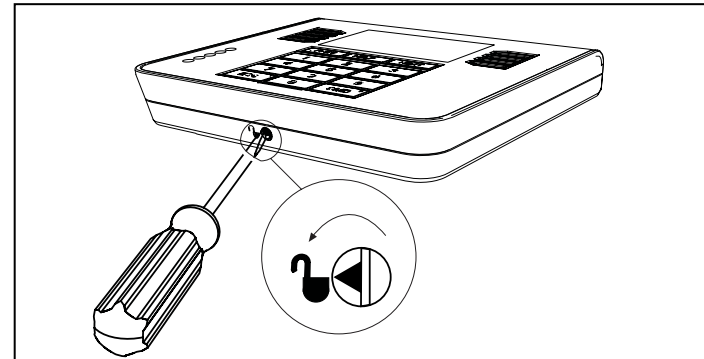

### Callout – Description

1 – Address switches
----------------------

## 2.2 | Setting the address switches

Set the address switches per the control panel configuration. Each SDI2 keypad must have a unique address. For single-digit addresses 1 through 9, set the tens switch to 0. The following illustration shows the address switch setting for address 1.

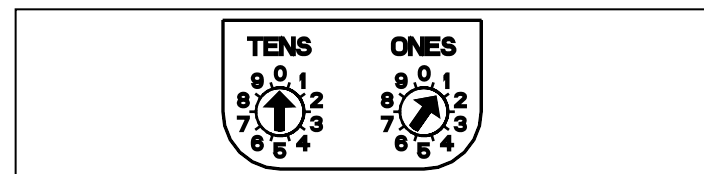

## 3 | Installation



### Caution!

To prevent personal injury and equipment damage, remove all power (AC and battery) before you make any connections.

## 3.1 | Install the keypad

You can surface install the keypad, or install it to standard electrical boxes, including single gang boxes.

1. Use the base as a template to mark surface.
2. Pull the wiring through the opening in the base.
3. Use the mounting hardware to attach.

## 3.2 | Attaching to the control panel

Use the control panel terminals labeled R, Y, G, B (PWR, A, B, COM). Connect them to the keypad terminals labeled R, Y, G, B.

Keypads can be wired directly to the control panel or from keypad to keypad.

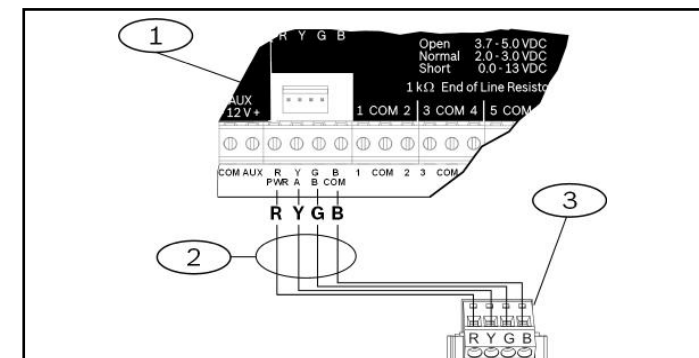

### Callout – Description

1 – Control panel
2 – Terminal wiring
3 – Keypad's SDI2 wiring terminal block

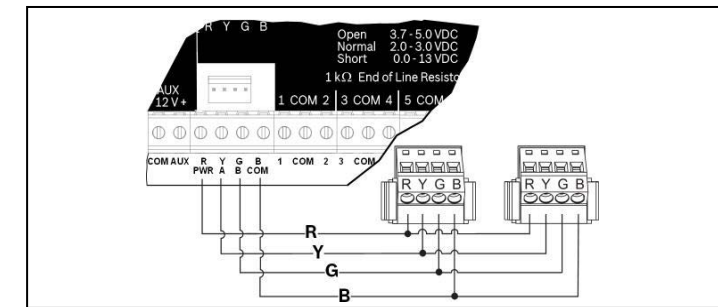

Reconnect the keypad to the base by sliding the keypad onto the base (reverse of Step 2). Apply power to the system.

## 4 | Display

Adjusting brightness:

1. Push [MENU] to open.
2. Push [NEXT] to go to the Press 5 for Settings Menu option, or press [5].
3. Push [NEXT] to go to the Press 4 for Keypad Config option, or press [4].
4. Push [1] to adjust the brightness.
5. Push [PREV] or [NEXT] to adjust the brightness. The changes apply immediately.
6. Push [ESC] to exit.

Adjusting nightlight (for control panels with version 2.01 or higher):

1. Push [MENU] to open.
2. Push [NEXT] to go to the Press 5 for Settings Menu option, or press [5].
3. Push [NEXT] to go to the Press 4 for Keypad Config option, or press [4].
4. Push [NEXT] to go to the Press 4 for Nightlight option, or press [4].
5. Push [PREV] or [NEXT] to toggle between Yes and No.
6. Push [ENTER] while viewing the option to save the programming.
7. Push [ESC] to exit.

## 5 | Status indicators

Status indicator	Function
✓	Ready to turn on (arm)
🔒	Turned on (armed)
⚠️	System trouble
GAS	Gas alarm
🔌	AC power present

## 6 | Audible tones

The keypad has a built-in speaker that produces several distinct warning tones.

Tone	Description
Fire alarm	Emits a pulsed, high-pitched bell tone.
Gas alarm	Emits a unique high pitched tone.
User alarm	The tone sounds for the programmed amount of time.
Burglary alarm	Emits a steady, high pitched bell tone.
Entry delay	Emits an intermittent beep tone during entry delay periods.
Exit delay	Emits an intermittent beep tone during exit delay.
Invalid button buzz	Emits a flat buzz tone.
Keypress	Emits a muted beep tone.
Trouble	Emits a two-tone warble until you enter a programmed passcode.
Watch point fault	Emits a single clean tweedle tone.

## 7 | Supervision

The control panel supervises all SDI2 devices. Any device that fails to respond will be declared missing.

## 8 | Firmware version

- To remove power to the keypad, remove it from the base.
  - Return the keypad to the base to restore power.
- The keypad shows the model number, keypad address, and firmware version for 10 seconds.



### NOTICE!

You can also view a keypad's firmware version in RPS.

## 9 | Keypad cleaning

Use a soft cloth or a non-abrasive cleaning solution. Spray the cleaner onto the cloth, not the keypad.

## 10 | Certifications

Region	Certification
US	UL 365 - Police Station Connected Burglar Alarm Units and Systems
	UL 609 - Local Burglar Alarm Units and Systems
	UL 985 - Household Fire Warning System Units
	UL 1023 - Household Burglar-Alarm System Units
	UL 1076 - Proprietary Burglar Alarm Units and Systems
	UL 1610 - Central Station Burglar Alarm Units
	CSFM - California Office of The State Fire Marshal
FCC Part 15 Class B	
CA	Canada CAN/ULC S303 - Local Burglar Alarm Units and Systems
	CAN/ULC S304 - Signal Receiving Centre and Premise Alarm Control Units
	ULC-ORD C1023 - Household Burglar Alarm System Units
	ULC-ORD C1076 - Proprietary Burglar Alarm Units and Systems
	ICES-003 - Digital Apparatus

## 11 | Specifications

Dimensions	6.2 in x 4.7 in x 1 in (158 mm x 120 mm x 26 mm)
Voltage (input)	12 VDC nominal
Current	35 mA in standby mode 80 mA in alarm mode
Operating temperature	0°C to +50°C (+32°F to +122°F)
Relative humidity	5% to 93% at +32°C (+90°F) non-condensing
Terminal wire size	12 AWG to 22 AWG (2 mm to 65 mm)
SDI2 wiring	Maximum distance - wire size (unshielded wire only): 1000 ft (305 m) - 22 AWG (0.65 mm)
Compatibility	B9512G/B9512G-E B8512G/B8512G-E B6512/B5512/B4512/B3512 D9412GV4 version 2.0 and higher D7412GV4 version 2.0 and higher (Refer to the control panel installation document for number of supported devices.)

### Copyright

This document is the intellectual property of Bosch Security Systems B.V. and is protected by copyright. All rights reserved.

### Trademarks

All hardware and software product names used in this document are likely to be registered trademarks and must be treated accordingly.

### Bosch Security Systems B.V. product manufacturing dates

Use the serial number located on the product label and refer to the Bosch Security Systems B.V. website at <http://www.boschsecurity.com/datecodes/>.



## ATM Style Alphanumeric Keypad (SDI2) B930



en Installation Guide

### Bosch Security Systems B.V.

Torenallee 49  
5617 BA Eindhoven  
Netherlands  
[www.boschsecurity.com](http://www.boschsecurity.com)

